



FACILITIES  
PLANNING  
OFFICE

DATE: 5/31/2017

FACILITIES DRAWINGS

HEALTH BUILDING #4  
PROPOSED SECOND FLOOR  
FLOOR PLAN & ROOM ID

REVISED: 5/31/2017 BY NIR PEARLSON ARCH.

UPDATED BY: JKP

SCALE: 1/16" = 1'

HEA-AR02A

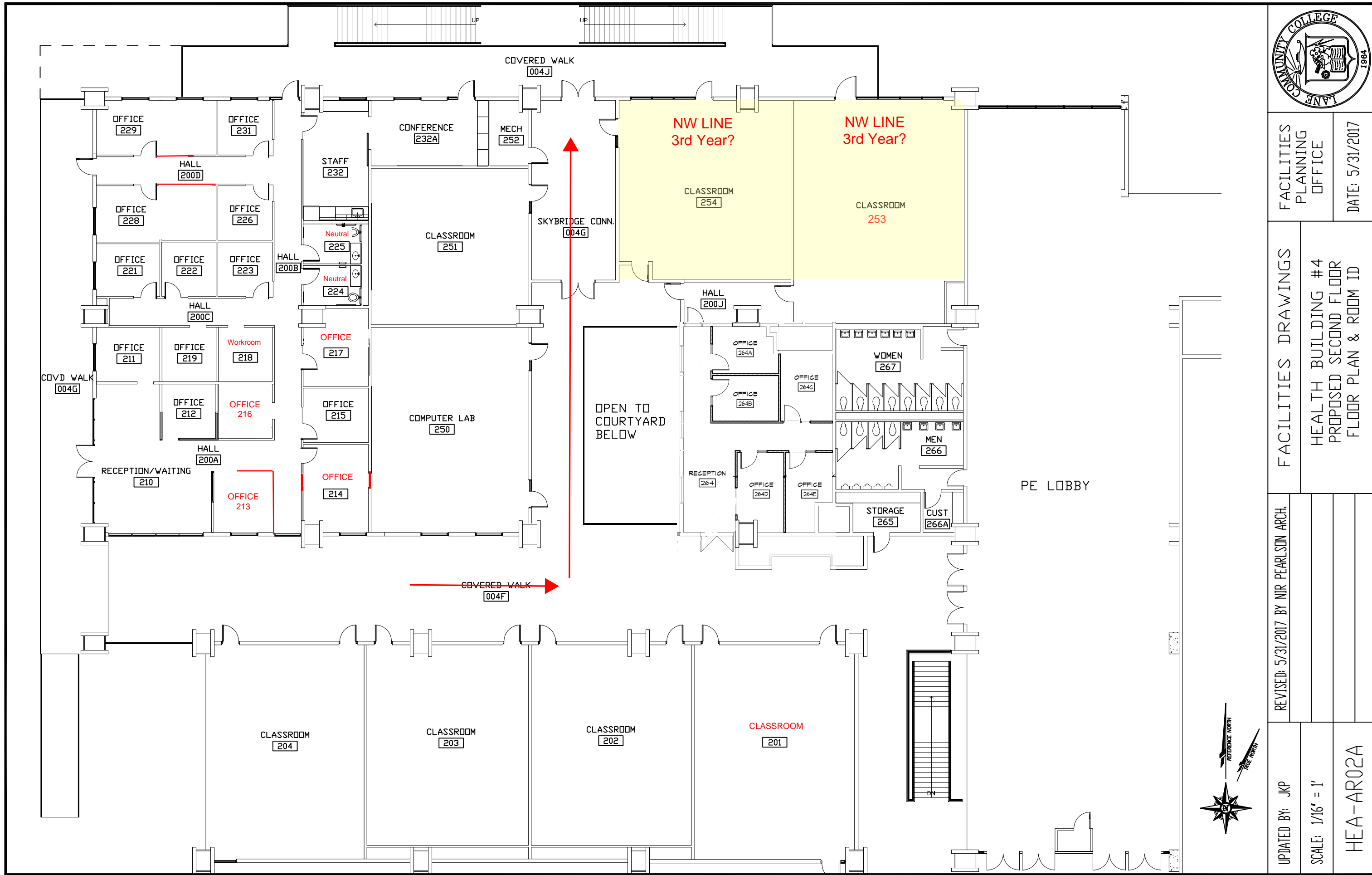

# Lane CC- Directions

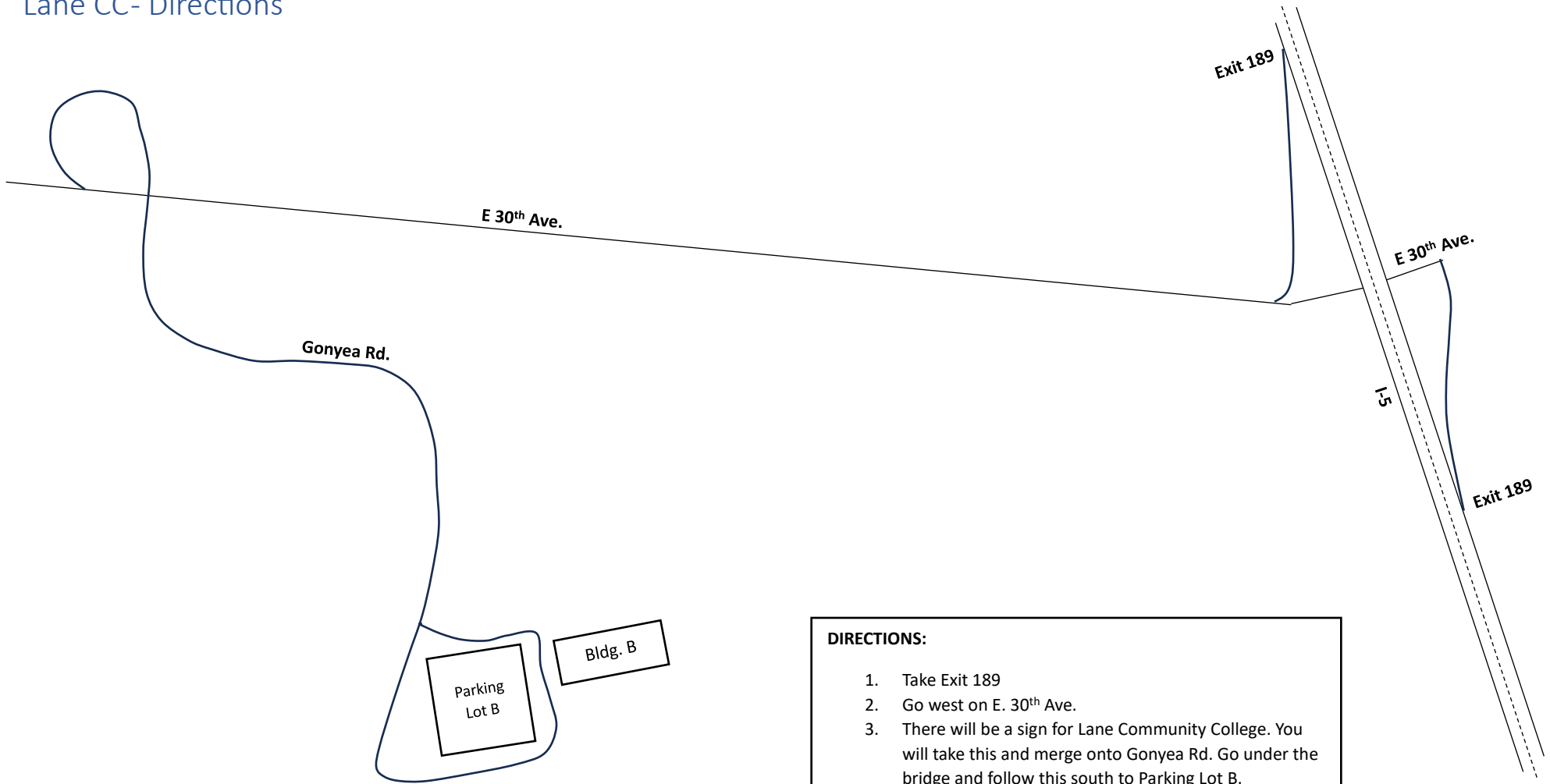

- DIRECTIONS:**
1. Take Exit 189
  2. Go west on E. 30<sup>th</sup> Ave.
  3. There will be a sign for Lane Community College. You will take this and merge onto Gonyea Rd. Go under the bridge and follow this south to Parking Lot B.
  4. On the east side of the parking lot is Building B.
  5. Classes are held in this building.
    - 1<sup>st</sup> Year - Room 202
    - 2<sup>nd</sup> Year - Room 203
    - 3<sup>rd</sup> Year – Room 204